

TREES OF WHOLE WORLD TO ARRIVE

Amateur botanists and other Richmond persons interested in tree culture will have an opportunity to observe the growth of some trees entirely new to this section of the world.

Word has been received by Walter Ratliff, in charge of the local government experimenting station, that 26 trees are being sent here by the department of agriculture for experimental purposes. The trees come from all parts of the world, and include both fruit and shade trees.

Following is a list of the trees that are to be planted on the station here:

Amygdalus Communis—Jordan almond from Spain. Good, hard-shelled variety grown in that country.

Amygdalus Persica—Vamqueser peach—Spain—Very early, and fine variety.

Amygdalus Persica Nectarina—Nectarine, for Quetta, British India, at altitudes ranging to 6,000 feet.

Berberis Hookeri—Virens—Barberry. Royal Botanical Gardens, Kew, Eng.

Evergreen shrub for Himalayas.

Cornus Capitala, Dogwood—From Heilvalop and China. Tree almost evergreen, strawberry shaped.

Corylus Wellana, Filbert—From France, called Daviana. Medium large variety.

Crataegus Stipulosa, Hawthorn—Guatemala. Like small apple. Makes fine jelly.

Cupressus Glabra—Cypress for Arizona. Bluish-green foliage.

Cupressus Thunbergii—White Cedar, Mexico. Pyramidal tree.

Diospyros Kaka—Persimmon. Introduced from Japan. Prolific variety.

Malus Sylvestris—Apple. Caucasus into Russia. Large white variety.

Malus Sylvestris—Apple. Aukland, New Zealand. "De White." Dark red, rich, fine flavor.

Morus Acidosa—Mulberry. China. Shrub or low tree. Dark red fruit.

Olea Ferruginea—Olive. Heinalaya. Beautifully mottled wood.

Olea Verrucosa—Wild Olive. South Africa.

Populus Ferolinensis—Berlin poplar. Lelanol, Russia. Shade tree.

Prunus Armerica—Apricot. Manchuria. Fruit red, medium sized.

Pterocarya Stenoptera—Walnut tree. China. Ornamental.

Pyrus Serotina—Pear. Turkestan. Juicy, medium sized fruit.

Rosa Odorata Gigantea. Rose. Himalayas. Large white.

Abies Numidica—Fir. Algeria. Handsome tree.

Betula. Schmidtii—Birch. Japan. Black bark, which is shed in thick plates.

Castanea Mollissima—Chestnut. Ichang, China.

Dahlia Cocinea—Dahlia. Guatemala. Grows wild at altitude of 7,000.

Liquidambar Formosana—Sweet Gum. China. Large tree.

Picea Hoyalmai—Tree. Japan. Reddish brown branches and bluish white leaves.

Pinus Bungeana—Pine. China. Tree white barked.

Salvia Gardueriana—Sage. Egypt.

CHOKED BY BAKED POTATO.

London, England—While lunching at the Hampden club, James Patterson MacMillan, 40, choked to death, when a hard lump of baked potato lodged in his throat.

MURINE A Wholesome, Cleansing, Refreshing and Healing Lotion—Murine for Redness, Soreness, Granulation, Itching and Burning of the Eyes or Eyelids. "3 Drops" After the Movies, Motoring or Golf will win your confidence. Ask your Druggist for Murine when your Eyes Need Care. Murine Eye Remedy Co., Chicago

LOWER PHONE RATE ASKED

INDIANAPOLIS, March 12.—The city of Muncie filed a petition with the public service commission for a rehearing of the Central Union Telephone company rate case as it applies to Muncie. The petition sets out that the rates at Muncie were increased over the Burleson rates, while the rates at Anderson were decreased.

Don't Risk the Flu—Kill that Cold!

DO YOU know that a bad cold is the beginning of most winter sickness? Can you afford to take chances on being sick—having the Flu—when doctor bills—and inability to work? Stop the cold right now when it is just starting—you can do it easily—in less than 24 hours if you take a few

LIGHTNING LAXATIVE QUININE TABLETS

Will Not Grip or Sicken

They are safe, reliable, satisfactory, used by thousands of households. You will say they are the best possible treatment for a cold. Try them—only 25 cents at your druggist or dealer.

Corn Pain Stopped Quick

"Gets-It" Loosens Them So They Lift Off in A Jiffy.

The corn pains cease as soon as a few drops of "Gets-It" reach the corn. It goes out of the hurting business forever.



For a day or so the corn remains, getting looser and looser and without a twinge from it. Then, it gets so loose that you just lift it right off, without even feeling it, and cast it away. That's how easily and simply "Gets-It" disposes of the corn nuisance.

"Gets-It," the unfailing, guaranteed, moneyback corn remover, costs but a trifle at any drug store. Mfd by E. Lawrence & Co., Chicago.

Specials—For Saturday Only



Men's \$9.00 Tan Blucher—

\$745

Men's \$9.00 Tan English—

\$745

Men's \$9 Tan Button—

\$745

Widths B, C and D Sizes 6 to 11

See our new Spring Low Shoes which are now in and ready for inspection.

Beckman & Kreimeier

Howard W. Beckman 708 Main St. Elmer B. Kreimeier

Boston Store

H. C. HASEMEIER CO.

Wool Dress Goods Reduced

A Sale of Wool Dress Goods which ought to command the attention of every woman who is interested in a genuine Saving. They are arranged in three groups and in fairness to the customer we ought to say that some are short pieces and will not last long, so we suggest you get in just as early as possible to take advantage of this saving.

Lot No. 1:

FANCY Novelty Wool Plaid; \$1.29 value—

GREY Novelty Wool Suiting; \$1.29 value—

GREY all Wool Vigeroux; \$1.25 value—

FANCY Novelty Plaid; \$1.29 value—

COPENHAGEN Hair Line Stripe; \$1.25 value—

BLACK Wool Storm Serge; \$1.25 value—

BLACK and White Wool Check; \$1.00 value—

BLACK and White Wool Check; \$1.29 value—

BLACK Stripe Suiting; \$1.00 value—

NAVY Blue Wool Ottoman; \$1.25 value—

NAVY Blue Wool Serge; \$1.00 value—

BLACK Wool Storm Serge; \$1.29 value—

BROWN Wool eSerge; \$1.29 value—

NAVY Blue Poplin; \$1.00 value—

CREAM Wool Poplin; \$1.00 value—

CREAM Wool Mohair; \$1.00 value—

36 to 38 Inch Widths

Choice

88c

Yard

Lot No. 2:

NOVELTY Dark Wine Plaid; \$1.50 value—

NOVELTY Tan Vigeroux Suiting; \$1.50 value—

PLAIN Red Storm Serge; \$1.50 value—

COPENHAGEN Novelty Wool Crepe; \$1.75 value—

NOVELTY Green and Blue Plaid; \$1.50 value—

GREY WOOL CREPE; \$1.75 value—

PLUM Wool Storm Serge; \$1.50 value—

NOVELTY Tan Wool Brocade; \$2.00 value—

WISTERIA Wool Poplin; \$1.50 value—

NOVELTY Black and White Stripe; \$1.50 value—

TAUPE and Green Novelty Plaid; \$1.50 value—

TERRA COTTA Wool Coating Plaid; \$2.00 value—

NAVY Blue All Wool Albatross; \$1.50 value—

PONGEE Silverbloom Skirting; \$1.50 value—

38 to 50 Inch Widths

Choice

\$1.29

Yard

Lot No. 3:

BLACK and White Stripe Suiting; \$3.00 value—

COPENHAGEN Blue Silk and Wool Poplin; \$3.00 value—

ALL WOOL Black and White Check Suiting; \$3.00 value—

ROSE SILK and Wool Poplin; \$3.00 value—

NAVY BLUE Shadow Stripe Serge; \$3.00 value—

PLUM SILK and Wool Poplin; \$3.00 value—

NAVY BLUE Striped Serge; \$3.50 value—

44 to 54 Inch Widths

Choice

\$2.38

Yard

WINE SILK and Wool Poplin; \$3.00 value—

NAVY BLUE Novelty Stripe Serge; \$3.50 value—

BROWN SILK and Wool Poplin; \$3.00 value—

DARK BROWN all Wool Coating; \$3.50 value—

NAVY BLUE Silk and Wool Poplin; \$3.00 value—

DARK BROWN Coating, all Wool; \$3.50 value—

ELSTRO'S Meat Market

Cor. S. 9th and E St.

Specials for Saturday

BEEF ROASTS 25c

PURE LARD 28c

Also BEEF, PORK and VEAL

"Home of Good Meats"

We grind you COFFEE the way you want it and roast it daily.

TRACY'S

BUY AN A-B-C Super-Electric Washer this month. Save \$15.00.

Weiss Furniture Store 505-513 Main St.

NO SAMPLES. NO LAY AWAYS. NO EXCHANGES

THE STORE WITH ONLY ONE PRICE



HAPPY, cheerful homes are the greatest blessings in the world. And almost always it is the WOMAN who makes the home happy.

Tired, over-worked women cannot be bright and cheerful. The miserable tedium of hard housework is too much.

You can make your work a great deal more pleasant, quicker and easier by using the wonderful new products that are made to lighten a woman's work.

For all household cleaning and washing, Joy Soap is a revelation. Dishes, windows, bath tubs, floors—all fairly sparkle when you use Joy.

It is so pleasant to work with—not a bit "soapy" or sticky. And it goes right after the dirt itself—you don't have to scrub it off. Joy cuts it off.

Joy is a cool, white soap with a fine, firm body that makes it last and last and last! Use Joy for all house cleaning and the laundry. It will help to lessen your work and make it far more pleasant. Ask your grocer.

joy soap (White)

"Works like a Wizard"

Louisville Food Products Co., Inc., Louisville, Ky.



REED'S REED'S

Spring Cleaning Needs

AT SAVING PRICES

A Good All Felt Mattress Priced at \$20.00

45 pounds combinations and cotton top mattress, priced from \$7.50 UP.

Make the Bed complete with a good spring—A good folding coil at \$5.85; others priced up to and including the famous De Lux at \$18.00

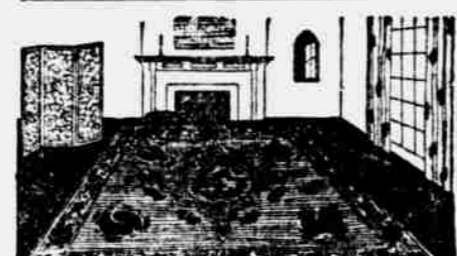
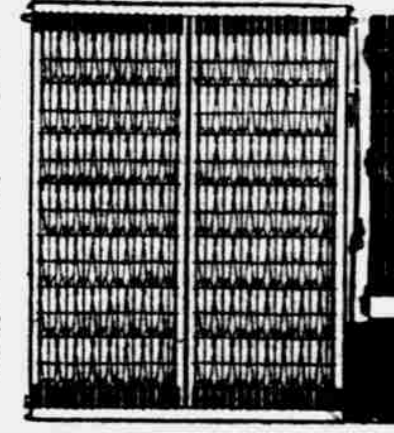

We have a generous display of Rugs in Tapestry, Velvet, Axminster, Wilton Velvet, Crex and Matting at prices that a real saving. Your selection held until you need it.

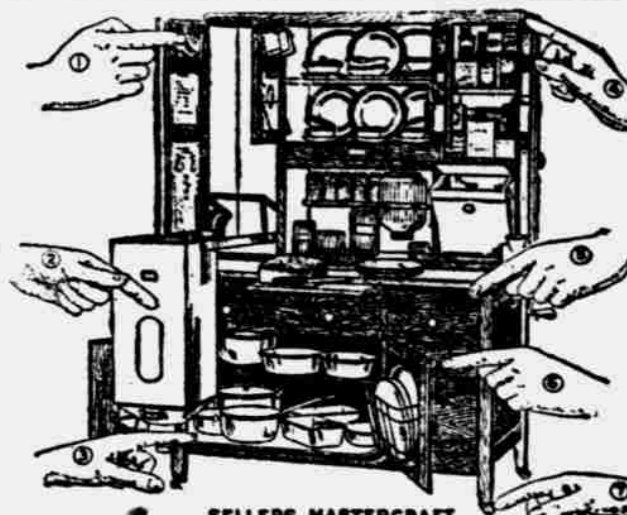

\$2.00 Down \$2.00 Each Week

SELLERS MASTERCRAFT

No. 1—Hand-matched Plank. Costs us \$9.75 extra, annually.
No. 2—Automatic Lowering Floor. Costs us \$20.00 extra, annually.
No. 3—Automatic Back Shelf Extender. Costs us \$9.00 extra, annually.
No. 4—Dresser. Costs us \$7.50 extra, annually.
No. 5—Dresser. Costs us \$7.50 extra, annually.
No. 6—Glass Kiosk. Costs us \$2.50 extra, annually.
No. 7—Antique Cabinet. Costs us \$10.00 extra, annually.

The Sellers Cabinet is not a leader by chance, it has this distinction because of the superior service and quality of the cabinet. The price of the Sellers is not a dollar more than other cabinets having none of the conveniences.



Immit and Print Linoleum in many designs in the best grade. We measure and lay your Linoleum without charge to you.



Special combination Liquid Veneer Mop and bottle of Polish. Extra large size—

\$1.98 \$1.98

\$1.00 Size of Polish Separate at 98c

REED'S



RICHMOND, IND. TENTH AND MAIN