

Wood Cabinets 95%

Wood kitchen cabinets were installed in 95 per cent of new homes built in the U.S. during the first quarter of 1959, according to a recent trade magazine survey.

Wood A-Plenty

Enough timber is grown in the Douglas fir region of western Washington and Oregon to build 1,000,000 homes every year... forever.

OLITE LIGHTWEIGHT Chimney Block

Economical Easy to Erect!

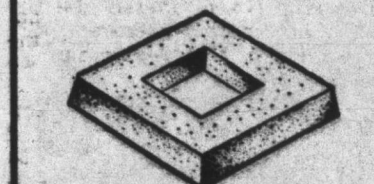

Reinforced concrete chimney cap for 8"x8" and 8"x12" flue. Protects block or brick chimneys.



Built-in round flue liner 8 1/2" diameter for lake cottages, small garages, etc.

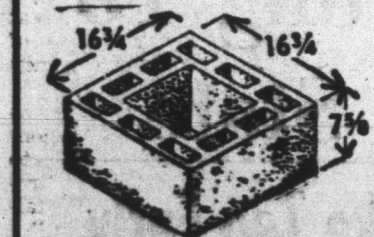

Square opening provided for standard 8"x8" flue liner. Meets building code requirements.

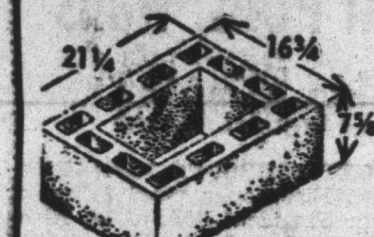

Rectangular opening provided for standard 8"x12" flue liner. Meets building code requirements.

AT YOUR LOCAL MASOLITE DEALERS

ADAMS COUNTY BUILDERS SUPPLY, INC.
309 S. 13th St. Decatur, Ind.

KOCHER LUMBER & COAL CO.
102 N. 1st St. Decatur, Ind.

Home Design Combines Colonial, Modern Styling

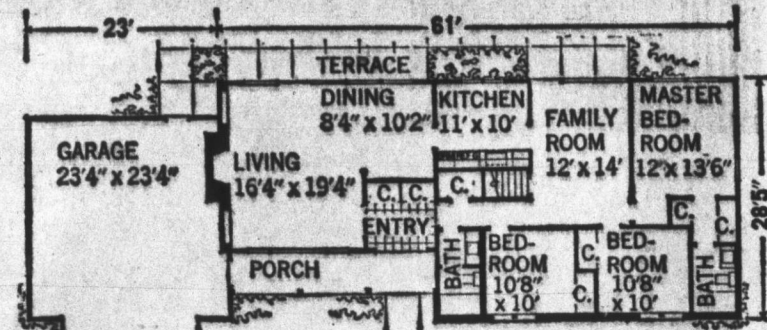

The current demand for Colonial-style homes is leading more and more architects to combine the advantages of traditional beauty with modern efficiency and low-cost construction methods.

One of these designs, shown above, is a long, low ranch-type house with Colonial styling inside and out by architect Irving E. Palmquist and designer Richard B. Pollman.

The needs of modern living are met by open planning, good zoning, and enough space on the single level for a growing active family.

Designers of the house have taken advantage of modern building materials to achieve the enduring Colonial look inside and out, and to keep construction costs down.

The rich, dark roof of asphalt shingles, for example, has a glare-free texture that complements traditional styling. Construction costs are kept low by the fact that asphalt shingles are low in applied cost.

Of equal importance to Colonial beauty are the windows of ponderosa pine and the panel doors throughout. These rich wood windows and doors—available as stock units from building material dealers—are authentic copies of models handmade by Early American craftsmen.

The house has a full basement, two-car garage, two baths, three bedrooms and a family room that can be converted for additional sleeping quarters.

For information regarding the availability of construction blueprints, material list, and specifications, write to Home Planners, Inc., 16310 Grand River, Detroit 27, Mich. Refer to Plan SR 966.

Snowy Roof Usually Means House Costs Less to Heat



Snow melts off roof of poorly insulated house, left, while neighboring home retains its coat of winter white. Latter is properly insulated with mineral wool, costs less to heat, and is more comfortable. Photo is unretouched.

When snow remains on your roof for days during a long winter's cold snap, is this good? Yes, say heating authorities. When snow stays on a roof for days during a cold spell, it usually means the house has been properly insulated, and therefore is more comfortable and economical to heat.

The photograph is a near-perfect example of this. These two similar homes in New York State house families of about the same size, and their demands for heat are nearly equal.

Yet snow is melted away on the roof of one, and is still encrusted on the roof of the other. This means that costly heat is escaping from the poorly insulated house on the left, melting the snow from beneath. But the house on the right is properly insulated with mineral wool. The snow won't melt until outside temperatures rise. The house is more comfortable, and its owners may be using 40 percent less fuel than their neighbors.

Annual Winterizing Is Vital Phase Of Economical Home Maintenance

Careful Checkup In Fall May Save Big Repair Bills

Getting a house ready for winter doesn't end merely with hanging storm windows and having the heating plant inspected.

Equally important is an inspection of the entire house and grounds to discover weak points that might break down under the onslaught of winter winds, snow, ice, and sleet.

Roof Important

These include loose shutters and siding, dead tree limbs that might be blown down to cause damage, a tottering TV antenna, crumbling mortar in chimneys and foundation, and such things as loose screening in attic vents that might entice squirrels or other rodents to take up residence.

Perhaps most important of all to a home's winter welfare is the condition of the roof. This is where winter's hardest blows land: scraping ice melting snow, severe temperature changes, harsh winds.

Leaks Are Threat

Most any home owner can get a fair idea of whether his roof will protect the house through the long winter by merely looking at it. If it looks shabby, it probably is worn out and will have to be replaced. A closer inspection can be made in the attic during a rainstorm. Darkened areas along deck boards and rafters indicate leaks. This means the entire roof is weak, since roofing material wears out uniformly.

When a roofing contractor confirms the home owner's analysis, chances are he'll recommend a new roof of asphalt shingles at a price that generally is a pleasant surprise. This is because asphalt shingles go in place quickly over old roofing material, keeping the labor cost of applying them at a low level.



Wise home owner swarms all over his house for pre-winter inspection. He caulks cracks around doors and windows, 1; repairs broken siding, 2; checks chimney and TV aerial, 3; insulates attic floor, 4; checks screening in ventilating louvers, 5; inspects roofing material, 6; caulk around foundation, 7; and inspects furnace, 8. A similar annual pre-winter check can save any home owner a lot of cold weather headaches.

House 'Detective' Can Find, Arrest Budget Robbers

Proper home maintenance is one of the most important aspects in the economics of home owning today.

Heating fuel is too costly to be wasted. Labor costs for major repair jobs—often the result of neglect—are high. Even a leaky water faucet can waste dollars worth of water if it is ignored for long.

Waste Avoided

Waste and damage through neglect can be avoided by semi-annual inspections by the home owner. He can caulk heat-wasting cracks at the foundation and around window and door frames, and install weatherstripping.

New washers eliminate water waste, and a fresh coat of paint can protect exposed surfaces against severe winter weathering.

Among the major causes of excess heat loss are insufficient insulation and the lack of storm sash and doors. Accessible areas such as attic floors, floors above crawl spaces, and the ceiling and wall of an attached, unheated garage can be insulated easily by the home owner with batts or blankets of mineral wool. Other wall and ceiling areas can be filled with mineral wool by a contractor with equipment that blows insulation into enclosed spaces.

Storm Sash Vital

Combination storm and screen doors and windows of ponderosa pine can be purchased from building material dealers in sizes to fit all requirements.

These wood combination units are preferred because wood is a natural insulating material and can be painted to harmonize with exterior color schemes.

A properly insulated house with storm sash and doors can be heated for as much as 50 per cent less per year than a house insulated to minimum FHA requirements without storm sash and doors.

Reroofing Job Can Be Done In Winter

Home owners today needn't wait until spring for a new roof if they discover their old one has given out in the dead of winter. A new roof of asphalt shingles can be applied in winter in most parts of the country, thanks to skilled application techniques and the versatility of the roofing material itself.

There are, in fact, even a couple of distinct advantages to reroofing in winter:

1. Roofing contractors generally are less busy. They can do the job at the homeowner's convenience, and will be less rushed, resulting in the small measure of extra care that provides a perfect roof.

2. The house gets immediate protection from the dangers of ice dams when asphalt shingles are applied by a reliable contractor.

Ice dams form in gutters in cold weather, blocking the flow-off of water from snow and ice melted by heat from inside the house. This water backs up under old or improperly applied roofing material and drips through decking boards into the house.

A proper application of asphalt shingles avoids this leakage with a flashing strip of heavy-duty asphalt roll roofing 36 inches wide applied along the entire length of the eaves. When water backs up under the shingles, this flashing strip keeps it from leaking into the house.

A new roof of asphalt shingles costs less than most home owners think, and is an eligible home improvement for an FHA Title I loan.

Indoor-Outdoor Room

New Porch Multiplies Space, Beautifies Entire House



After—New porch enclosed with combination doors of ponderosa pine adds new beauty to house, provides sun room in winter, screened porch in summer.

An enclosed porch can do wonders for most any house. It can serve as a family room, dining room, entertainment center, and as an extra bedroom.

The porch recently added to the home of Mr. and Mrs. John McQuade, of Crugers, N.Y., gave them all these things and more: a solarium in winter, a screened porch in summer, plus a panoramic view of the Hudson River all year round.

This is because the McQuades, budget-minded parents of five school-age-and-under children, enclosed their porch with combination storm and screen doors of ponderosa pine.

The combination doors, nailed together around three sides of the porch, provide complete walls as well as glass inserts for winter and screen inserts for summer.

The McQuades, who found the idea for their porch in a magazine, selected stock ponderosa pine combination doors seven feet tall and three feet wide with glass/screen inserts that occupy about half of the door's height. The lower half consists of panels that give the porch a luxurious custom-paneled look inside and out.

When the McQuades first moved into their house, it was a tall, boxy affair with a small living room and no dining area or space for recreation or entertainment.

The builder had provided sliding glass doors leading from the living room onto a muddy rear yard on the river-view side of the house.

When porch-building day arrived, the McQuades' contractor erected a cinder block foundation, a plywood floor and a gently sloping shed roof supported by 4x4-inch posts spaced 3 feet apart. The doors were fitted between these posts, with molding covering the joints.

DECATUR READY-MIX CONCRETE

THE *Right* MIX FOR EVERY JOB

DECATUR READY-MIX CORP.
PHONE 3-2561
E. OAK and FURNACE STREETS

HUMPHREY TENSION SEALED Aluminum



SEE FOR YOURSELF... These removable inserts... Screen panel insert... Outer glass insert... Movable glass panel insert. Indirect draft-free ventilation in any weather.

EASY TERMS - To Suit Your Budget - For Free Estimate, Call—

Kohne Window & Awning Co.
711 Winchester St. Phone 3-2259
JOHN KOHNE

Your Builder Will Do Quality Work WITH YOST READY-MIX CONCRETE

We mix concrete to your specifications, deliver it RIGHT at your job, ready to pour. Get our prices.

10% Discount ON ALL READY MIX CONCRETE

CALL 3-3114
GET OUR PRICES — PROVE FOR YOURSELF YOU GET THE BEST FOR LESS!

Yost Gravel-Readymix, Inc.
Phone 3-3114 Decatur R. D. 1

GET A GAS PERMIT?

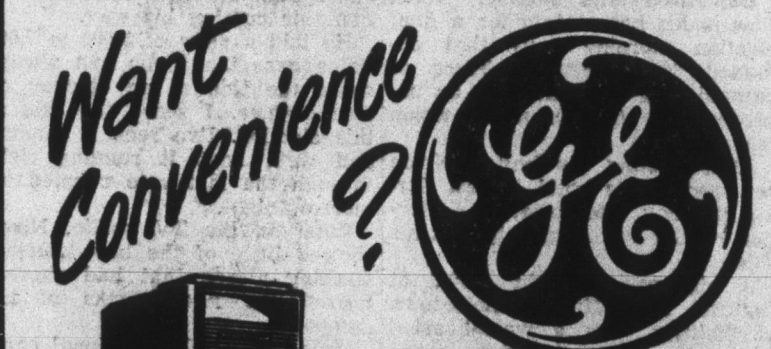

WANT Convenience? *GE* GAS FURNACE
No more "looking after" the furnace. G-E automatic heating ends fuss and bother.

for a FREE Estimate
Phone 3-2615

ASHBAUCHERS' TIN SHOP

Established 1915
Heating, Roofing, Siding, Spouting, Air Conditioning
116 N. 1st St. Decatur, Ind. Phone 3-2615

Get ready for winter now!

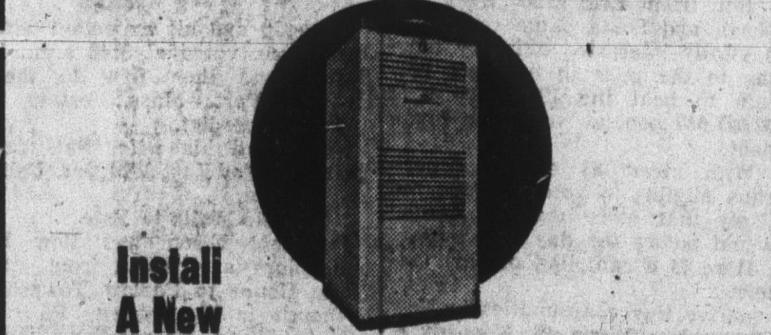

Install A New OIL or GAS AMERICAN FURNACE
Get complete home comfort with AFCCO COMFORTMAKER winter air conditioning — Temperature control — Humidity control — Filtered Air — Low cost operation.
For a free estimate — Call

HAUGS HEATING — PLUMBING — APPLIANCES
AIR CONDITIONING
209 N. 13th St. Phone 3-3116

You can do it—

BUILD A COOK'S KITCHEN!

WE HAVE EVERYTHING YOU NEED TO REMODEL YOUR KITCHEN.

- FORMICA
- MARLITE
- VINYL FLOOR TILE
- PLASTIC WALL TILE
- KITCHEN-AID DISHWASHERS
- STAINLESS STEEL SINKS
- TOWN & COUNTRY DISPOSALS
- BUILT-IN OVENS AND RANGES.

OPEN EVERY FRIDAY NIGHT
FREE CONSULTATION

ARNOLD LUMBER CO., INC.
"Your Complete Builders Supply Department Store"
Winchester Street at Erie R.R. Crossing
OPEN FRIDAY 'TIL 9:00 P. M. FOR YOUR SHOPPING

New Decor

A new and attractive ceiling for a living room was created by one architect who used exposed 2x4s of Douglas fir on six-inch centers with interesting patterns of random spaced 1x2 and 2x4 dividers in geometric styling.

Hobby Corner

People who have a hobby like photography or ceramics like homes with basements, for it gives them space to work. Wood floors are also easier on the feet.

For Amateurs

You don't have to be an expert to build with wood.

SUNNY HEATING SAYS

"Pay your fuel oil bills in small payments with the Mobilheat Balanced Budget Plan"

Mobilheat

PETRIE OIL CO.
PHONE 3-2014

Louver Shutters Neatly Close Off Double Doorway

The problem of an outsize opening between rooms can be solved neatly and beautifully, as the drawing shows, with folding louver shutters of ponderosa pine. The shutters fold neatly out of the way when not in use, and the louvers add richness and charm to any decor, modern or traditional. Shutters and louver doors of ponderosa pine are stocked in a wide range of sizes by building material dealers.